

Tuscany by the Sea

Residence 402

Tuscany by the Sea is the Premier Condominium Residence on Pinellas Beaches and Residence 402 is an exceptional custom beach home offering 80 feet of direct frontage along the beautiful blue warm waters of the Gulf of Mexico.

This custom home is well appointed with gorgeous hardwood flooring throughout, custom two toned wood kitchen cabinets, gas cooking, central vacuuming, crown molding throughout, custom paint, huge walk in pantry and so much more. You can walk from your spa like master bath to the breakfast room and never take your eyes off the spectacular view.

The generous Master suite is spacious and offers a spa bath with dual vanities, his and her closets, separate jetted tub, custom shower and a separate sitting area that is currently being used as an office

The en-suite guest rooms are spacious and well appointed.

This private beach residence offers gated and secured 2 car garage with ample guest parking.

Tuscany by the Sea offers more than what you will find in a Single Family Beach Home without the concerns of maintenance. Each Residence spans 80 feet across the beach and views of the beautiful coastline along with a few city light views to the north.

4 en-suite Guest Rooms 5 Bathrooms
Separate office and Media/Den
5400 sq.ft. of Luxury appointments
Ample Storage throughout
Breathtaking Views
Expansive Terrace

Jennifer Blackwell

The Seaside
 REAL ESTATE STORE

North Floor Plan

Gulf of Mexico

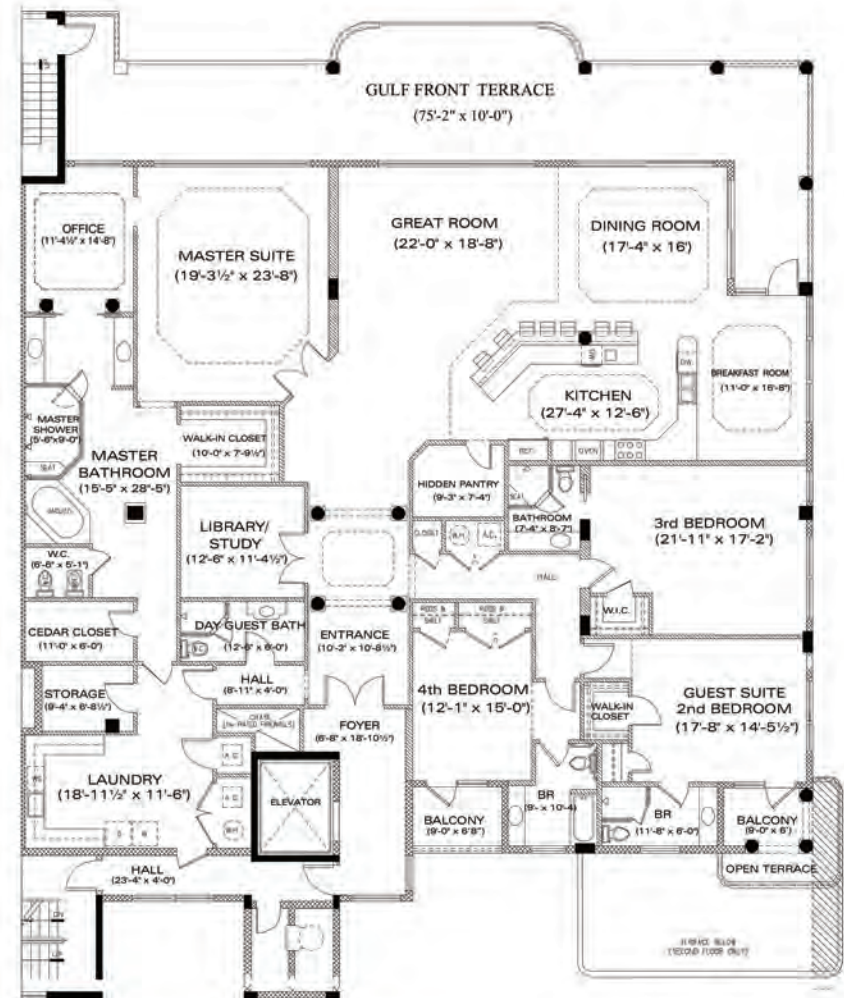

Indoor Living Area - 5400 Sq.Ft.
 Outdoor Living Area - 1202 Sq.Ft.
 (Terrace Level Outdoor Living Area 2300(mol) Sq.Ft.)

Offering Price: \$2,895,000

j@sandforsale.com
www.theseaside realestatestore.com
www.sandforsale.com

727.580.8821